

CHAIR

TECHNICAL DESCRIPTION



1. Concept:

CHAIR is the new office chair collection, designed by Vincent van Duysen for Bulo. The refined chair is characterised by pure lines, a specific profile, remarkable ergonomic qualities and the use of innovative materials. The height adjustment knobs are made of ceramic, which is pleasant to the touch. The colours of the covering, the frame and the side profile can be attuned, thus creating a monochromatic chair.

2. Frame

Metal frame with tilting mechanism

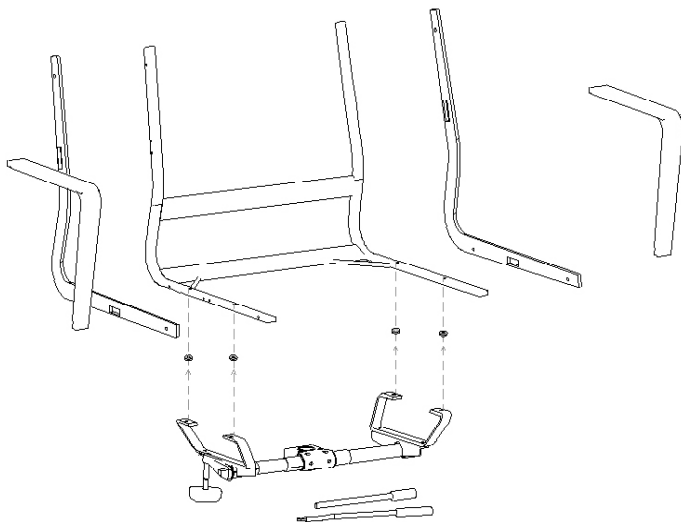

Use of the new ilira stretch material (flat underside), which provides a lot of comfort and makes it possible to have an exceptionally fine and light shape.

2. Types

OFFICE CHAIR - office chair with tilting mechanism, on a 5-star shaped base on wheels

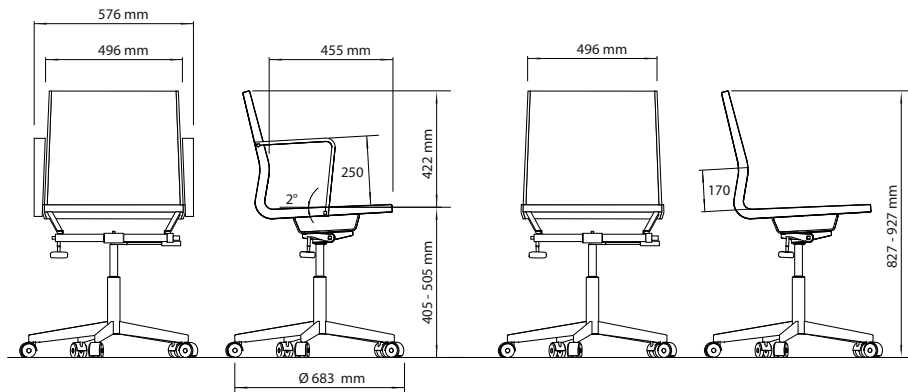

VISITOR'S CHAIR - visitor's chair with a fixed base, on a 4-star shaped base on wheels or on glides.

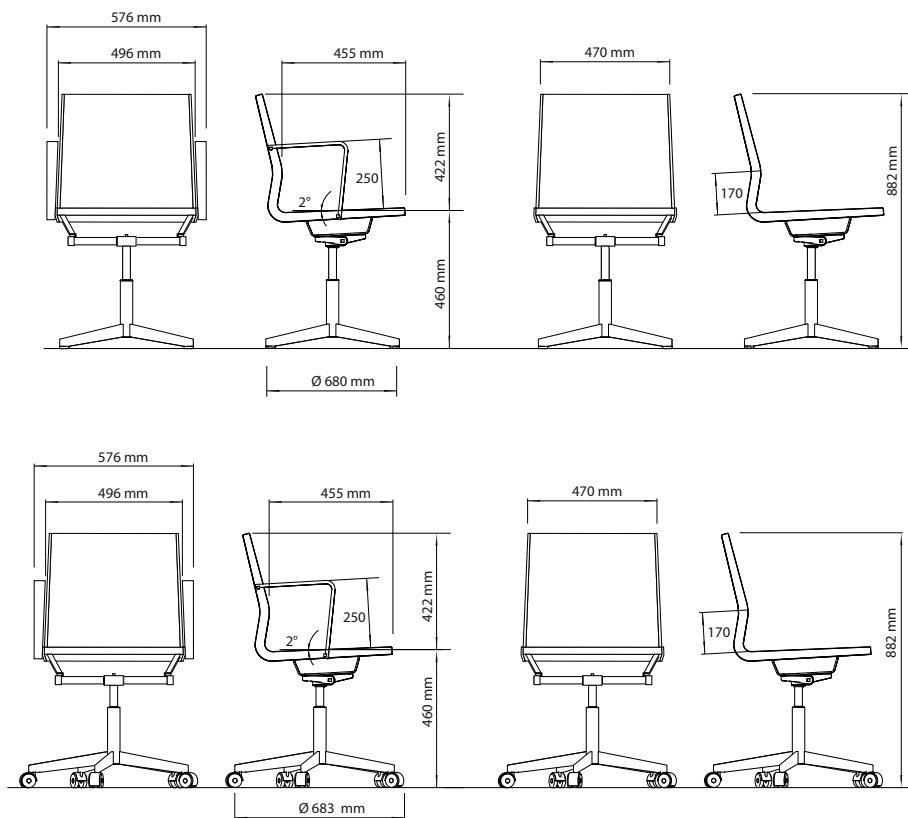

3. Ergonomics

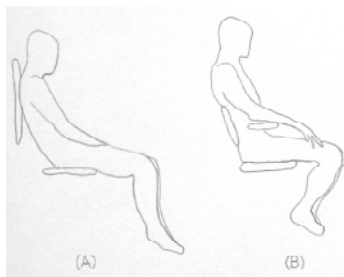

Medium high back for free shoulder blade space (more freedom of movement, more support for the lumbar vertebrae, and no danger of slumping down with a bent back – see also the diagrams

Seat gradient of 4.5° presents slumping down with a bent back, gives a good feel when sitting (Chris Snijders, ergonomist), is necessary for a good sitting position, and ideal support for the pelvis (Hugo Bos, physiotherapist and ergonomics manager).

The following adjustments are possible:

- height adjustment
- weight adjustment
- locking the mechanism in the selected position

The handles are produced in white glazed porcelain. This gives the chair a certain added value. It also fits in with the total concept of the chair; use of base materials such as steel, divina fabric (felt), and ceramics.

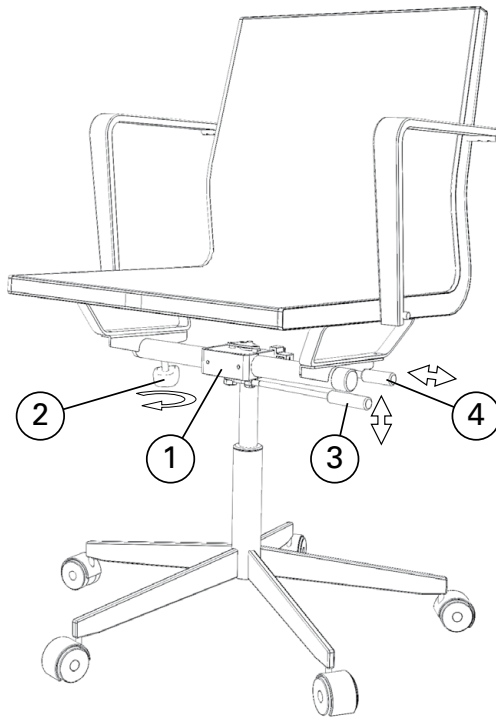

1. Tilt mechanism based on a torsion bar
2. Adjustment to the body weight
3. Seat height adjustment
4. Fixation of the tilt mechanism

4. Finishes

BASE

lacquered lily white
lacquered light grey
lacquered cargo grey
lacquered coffee bean
stainless steel

ARM REST

no arm rests
oak plywood
walnut plywood
padouk plywood
wengé plywood

SIDE PROFILE

lacquered lily white
lacquered light grey
lacquered cargo grey
lacquered coffee bean
oak veneer
walnut veneer
padouk veneer
wengé veneer

MATERIAL

fabric Divina light grey
fabric Divina cargo grey
fabric Divina coffee bean
Leather ...

CASTORS/GLIDES

hard castors
soft castors
felt glides
Plastic glides

